

# Your Modular Building Solution Provider

安捷诚栋 您的模块解决方案专家



安捷诚栋国际集成房屋（北京）有限公司（简称 安捷诚栋）  
主要从事中国及国际市场的箱式房租赁和销售业务。

安捷诚栋国际集成房屋（北京）有限公司

📍 地址：北京市通州区宋庄镇南街6号-2 邮编：101118

🌐 网址：www.algecochengdong.com.cn

✉ 邮箱：info@algecochengdong.com.cn

☎ 400-090-9898



## Your Modular Building Solution Provider

安捷诚栋>



安捷诚栋 您的模块解决方案专家



## 总裁致辞

### General Manager's Welcome Introduction



Anil Karnatak  
总裁 General Manager

安捷诚栋：您的模块化空间供应商

六十多年前，Algeco首创了模块化建筑的概念。现如今，Algeco已经成为了全球领先的商业服务供应商，专注于模块化空间及安全存储解决方案，在全球29个国家拥有超过30万个模块单元用于租赁。

Algeco与北京诚栋投资设立的安捷诚栋于2014年成立。合资公司充分发挥了双方的专业优势和宝贵经验。

我们为能够提供新颖安全，灵活舒适，经济环保的模块化产品及服务感到荣幸。除传统的销售业务外，安捷诚栋将租赁业务作为其核心专长。

作为一个学习型组织，我们以善于倾听、学习以及追求提供卓越的客户体验而持续不断改进为荣。

我们的愿景是塑造一支充满活力的团队，通过模块建筑的任意组合为客户提供无限的服务，引领行业的发展。

Algeco Chengdong: Your Modular Space Provider

More than 60 years ago, Algeco created the concept of the modular building. Today Algeco is the leading global business service provider focused on modular space & secure storage solutions, with a fleet of more than 300,000 modules in 29 countries.

In China, the joint-venture AlgecoChengdong, created in 2014, leverages the expertise and the best practices of its 2 founders Algeco Scotsman and Beijing Chengdong International, a well-established Chinese expert of temporary buildings.

We are proud to offer innovative, safe, flexible, comfortable, environment-friendly, economical modular space products and services. In addition to classical sales, AlgecoChengdong has made rental business its core expertise.

As a learning organization, we pride ourselves in our ability to listen, learn and continuously improve in the pursuit of providing a superior customer experience.

Our Vision is that our inspired team will lead the industry by providing limitless space possibilities for our customers.

Anil Karnatak

总裁  
安捷诚栋国际集成房屋（北京）有限公司

General Manager  
Algeco Chengdong International Modular Housing Co.,ltd.

## 目录 Directory

目录(Directory) .....	1
总裁致辞 ( General Manager' s Welcome Introduction ) .....	2
安捷诚栋简介 ( Company Profile ) .....	3-4
安捷诚栋优势 ( Advantages of us ) .....	5-6
为什么选择模块房 ( Why Modular ? ) .....	7-8
产品技术参数 ( Product Specification ) .....	9-10
产品展示 ( Standard Configurations ) .....	11-18
完备的解决方案 ( Introduction of 360° solutions ) .....	19
租赁服务 ( Advantages of Leasing ) .....	20
拆装移地 ( Project Transfer & Relocation ) .....	21-22
配套产品及方案 ( Ancillary Products and Solutions ) .....	23-26
项目案例 ( Case studies ) .....	27-38



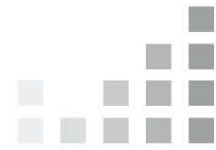

## 安捷诚栋简介 Company Profile

安捷诚栋国际集成房屋（北京）有限公司（简称安捷诚栋）是由全球领先的模块房空间服务商—Algeco和中国集成房屋领导企业—北京诚栋国际营地集成房屋股份有限公司联合出资共同创立的合资企业。合资公司将充分发挥双方的优势，为客户提供满足其需求的模块房解决方案。

安捷诚栋模块房产品设计基于最佳的国际技术，同时充分结合中国当地的行业标准，所用材料防火且环保。创新设计以及部件的精心选择，为您提供一个更安全、更舒适、更环保的产品。产品坚固结实、防火性能优良、保温密封及隔音效果良好等特征，使安捷诚栋模块房较中国的同类产品有了重大突破。此外，除了传统的临时办公室、会议室、仓储和宿舍用房外，安捷诚栋模块房同样适合用于永久性办公用房、学校、医院、大型活动及VIP用房。

安捷诚栋在充分借鉴Algeco近半个多世纪不断改良的、先进的模块房租赁服务模式基础上，充分结合中国消费者的实际需求，积极地寻求创新和突破，为中国客户提供具有国际化标准的服务体验。让您充分享受模块房租赁所给您带来的轻松和益处。

安捷诚栋，以其全新的模块房产品及租赁服务模式，必将引领中国集成房屋行业发展的新方向，成为行业转型升级的助推器，为整个集成房屋行业注入新的血液。让我们与全体行业同仁一起携手，共同谱写集成房屋行业的新篇章！

Algeco Chengdong International Modular Housing Co.,Ltd. (Algeco Chengdong), is a Sino-Foreign equity joint venture company established by Algeco (the inventor and leader of modular space worldwide) and Beijing Chengdong International Modular Housing Corporation. (a leader of integrated houses in China). The joint venture company is to leverage the strength and expertise of both experienced companies, to provide solutions that fit to customer's needs.

The modular housing designed by Algeco Chengdong is engineered from international best practices and adapted to local regulations and standards. The materials used for the components of the modules are non-combustibles and respectful of the environment. The innovative design and choice of components provide a safer, more comfortable and more environmental friendly product. Robustness, non combustibility, high insulation, air-tightness, sound insulation are characteristics that makes AlgecoChengdong modules a breakthrough product in China. Therefore, besides traditional use for temporary office, meeting room, storage and dormitory, Algeco Chengdong's module is also suitable for permanent office, school, hospital, event, VIP room...

Based on Algeco advanced modular space leasing service model, which has been constantly improving over half a century, integrated with the actual needs of Chinese customers, AlgecoChengdong is developing innovations and breakthroughs in a proactive way, to provide Chinese customers a service experience with international standards, and to allow you fully enjoy the ease and benefits of modular space leasing..

Algeco Chengdong, with its improved modular products and mature leasing service model, will certainly lead the new direction of Chinese modular housing industry, becomes the leader of modular space provider and secure storage solution in China. Let us work together to develop a new world of modular housing business!



关注我们 | Follow us



# 安捷诚栋优势 Advantages of Algeco Chengdong



租赁项目，配家具

## +先进成熟的租赁模式

AS的租赁服务是一种更环保、便捷的业务模式，已被全球多个国家和客户所青睐。今天，安捷诚栋延续这种成熟的模式，为中国客户带来全新的合作体验。

## Modern Leasing business mode

Based on AS successful operating experience over half a century, we are offering this modern and convenient service to China market as well.

## +国际背景，模块房创始者 (Algeco) 与国内行业领导者 (诚栋营地)，强强联手

全球模块房创始者，拥有60多年行业经验，在租模块数量达到30万。

拥有多项世界级专利并在严格的欧洲地区获得权威认证。

在全球拥有200多个分支机构以及数十个研发中心。业务遍布全球50多个国家，超过80000个客户，产品广泛服务于多个领域，满足不同客户需求。



营地服务

## +产品成熟，设计领先，高度 灵活性，后期维护成本基本 为“0”

专利型KEY系统，保证房体如“LEGO”般灵活拆装  
房体无需打钉打胶，后期维护成本基本为“0”

## Advanced product design, “0” maintenance cost

The unique Key-system enables high flexibility, installation and dismantling works just easy like “LEGO”.

No silicon, No nailing, Panels 100% identical and not damaged,  
“0” maintenance cost.

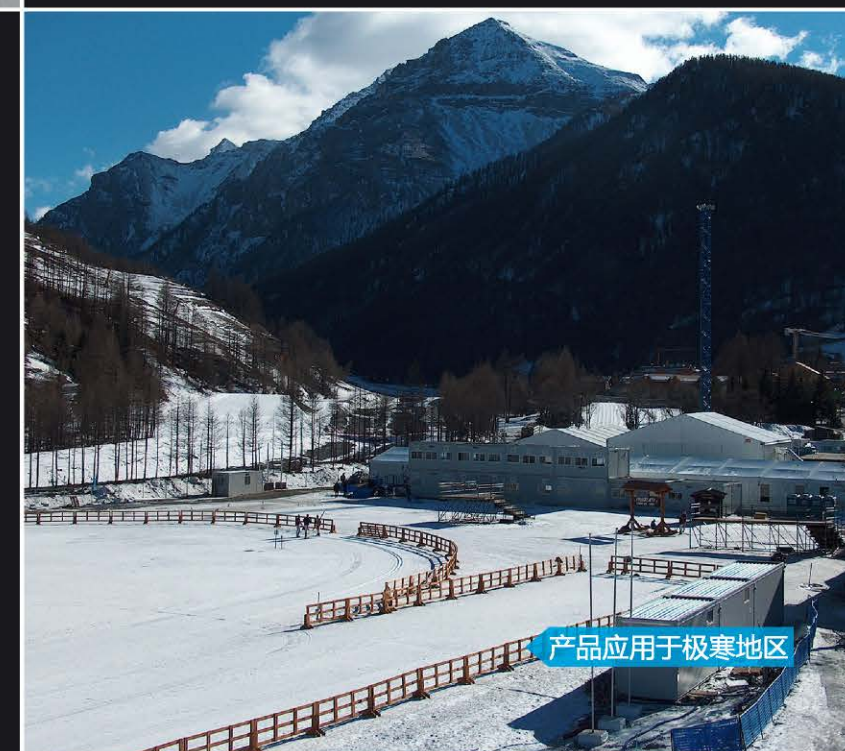

产品应用于极寒地区

## Combination of the forces

Inventor and worldwide leader of modular building for more than 60 years, leasing fleet over 300,000 units all over the world.

With number of world patents, especially in Europe.

More than 200 Service and Design Centers in 50 countries, over 80,000 customers for very diversified applications.

## +欧洲标准，更高安全性

成熟的欧洲屋顶技术，更高承重性，配有安全环及防坠设计  
严格计算，满足3层使用  
关注施工安全及人身安全防护

## Advanced European standard, high safety

Classic European roof techniques, provided with safety ring, corrugated roof panels and non-slip design.

Statics based on wind, snow, seismic conditions, meet requirement for 3 storeys.

Keep attention to the safety in construction and personal.



欧洲专利型屋顶设计

## +全方位360服务体系—解决 方案提供者

沿袭AS全球360服务体系，我们向中国客户继续推行360度全方位服务，即使只是一个墙板打孔，我们都完备的解决方案。

## Solution Provider

In Algeco chengdong, we implement AS world wide 360 degree service in China, being the one stop shop, provide turnkey solutions with the seamless experience and perfect details of product.



# 为什么选择模块房 >

## Why Modular ?



### 1 预制化

安全，质量管控，快速交货

- 生产活动与现场工作同时进行，缩短工期
- 生产活动在有环境管控的工厂内进行
- 消除了外界的不利影响，例如：天气原因耽误工期
- 最少的现场干扰，提高用户和场地所有者的安全性
- 快速安装

### Prefabricated

Safety, quality control, short lead-time

- Manufacture takes place concurrently with site works, reducing project time
- Manufacture undertaken in a factory controlled environment
- Negating the effect of external influences such as weather that can delay build time
- Minimizing site disruption, enhancing safety for sites occupants and users
- Fast installation

### 2 灵活性

产品标准，简约，便于根据客户需求进行调整

- 可无限横向连接，纵向可达3层
- 可根据客户需求进行室内布局设计
- 项目使用期间可进行灵活调整
- 房屋内外美观度可根据客户需求定制化

### Flexibility

Standard, simple and convenient to adapt to customer needs

- Unlimited horizontal configuration, up to 3 storeys
- Internal layout adapted to customers' need
- Flexibility during the life of the project for adjustment
- External and internal aesthetic that can be customized

### 3 节能环保

- 在模块房设计和材料选择时秉承环保理念
- 产品预制化确保了工地现场的“零垃圾”
- 工程结束后，模块房可轻松移走，使场地恢复原貌
- 由于模块房可在不同项目中重复使用多次，因此实现了真正的可持续发展的商业模式

### Environment Friendly

- Design of the module and material choice in respect of environment
- Prefabrication to ensure the concept of “zero waste” on site
- Modules easily removable at the end of the project, letting the site in his initial conditions and appearance
- Real sustainable business model thanks to the possibility to re-use several time the module for different projects



产品参数 >
Product Specification



三款不同系列产品供您选择：
3 series products to meet different requirements:

Flex 灵活型
Flex Series

彰显品质，高档之选 >

产品特点：Features

- 确保无损拆装的专利型Key系统 Patented Key system
- 独立墙板拆装体系（无电线，无损害性固定方式，无打胶）Independent panels (no electrical cable, no destructive fixing, no silicon)
- 可拆换吊顶 Removable ceiling
- 有叉车孔 Forklift pocket

优势：Advantages

- 产品寿命最长，拆装移地成本最低 Long lifecycle, Transfer at lowest cost
- 维修保养及布局改变，效率最高 Most efficient maintenance and change of configuration
- 支持回购 Buy-back option
- 支持租赁 For Leasing

ADV 舒适型
ADV Series

精工细制，舒适之选 >

产品特点：Features

- 确保无损拆装的专利型Key系统 Panted Key system
- 独立墙板拆装体系（无电线，无损害性固定方式，无打胶）Independent panels (no electrical cable, no destructive fixing, no silicon)
- 可拆换吊顶 Removable ceiling

优势：Advantages

- 拆装移地成本最低 Transfer at lowest cost
- 维修保养及布局改变，效率最高 Most efficient maintenance and change of configuration
- 支持回购 Buy-back option
- 支持销售 For Selling

ECO 经济型
ECO Series

合理节约，经济之选 >

产品特点：Features

- 独立墙板拆装体系（无电线，无损害性固定方式，无打胶）Independent panels (no electrical cable, no destructive fixing, no silicon)
- 可拆换吊顶 Removable ceiling

优势：Advantages

- 拆装移地成本最低 Transfer at lowest cost
- 维修保养及布局改变，效率较高 Efficient Maintenance, change of configuration
- 支持销售 For Selling

定制化产品
Customization

高端定制，适用之选 >

除标准产品外，我们更向您提供定制化服务，多种房体配套供您选择，如：玻璃窗，露台，防腐木装饰等。布局可根据您的需求定制：内走廊设计、房间空间调整等。

We' ll be pleased to offer customized service for you, lots of ancillary products for you to choose. Eg. Glass wall, terrace, wooden stair & corridor, canopy, decorative strip, ect..., In addition, the layout of the module, the size for each room can also be adjusted by your requirements.

1 尺寸 Size

- 外尺寸(L\*W\*H) External Size
6055\*2990\*2896mm
- 内尺寸(L\*W\*H) Internal Size
5840\*2775\*2540mm

3 屋面 Roof

- 屋面瓦—源于欧洲设计
Roof Tile – European technology
0.5mm厚彩钢屋面瓦
0.5mm colour steel roof tile
防腐镀锌喷涂
galvanized painted
质保期长达15年
15 years warranty
- 保温材料 Insulation
玻璃丝棉(14kg/m³) 100mm厚单面铝箔卷粘
glass wool unit weight:14kg/m³, thickness:100mm
- 可替换型金属吊顶
Removable metallic ceiling
0.4mm彩钢单板（R9018）白色
0.4mm color steel plate (R9018) white

5 门 Door

- 外门 door
钢质门，尺寸：W840\*H2035，颜色（R9018）
Standard Steel Door, Size: W840\*H2035, Color (R9018)

2 结构 Frame

- 主要型材 Profile Steel
4mm 厚镀锌地面框架梁，4mm 厚镀锌屋面框架梁，3mm 镀锌立柱
4mm galvanized beams for floor frame and roof frame, 3mm galvanized column
- 结构连接 Connector
M12\*40 高强螺栓，摩擦型（内六角）
M12\*40 high strength bolt (inside hexagonal bolt )
- 表面处理 Treatment
白色喷漆（R9018）镀锌含量双面100g/m²
white spray painting (R9018) galvanized,100g/m²

4 地面 Floor

- 底面板 Bottom
0.3mm彩钢单板（R9018）白色
0.3mm color steel plate (R9018) white
- 保温材料 Insulation
玻璃丝棉(14kg/m³)，单面铝箔卷粘
glass wool unit weight:14kg/m³
结构板 Structural Slab 19mm水泥刨花板，密度1300kg/m³
19mm cement-bonded, unit weight:1300kg/m³
- 地面处理 Treatment
PVC塑胶地板，2mm厚(环保型)
environmental protection PVC flooring,thickness: 2mm

6 电气 electric

为保证更好的安全性及使用期，我们的灯具、插座全部采用品牌产品。
High quality electrical equipment to ensure better safety and longer lifecycle.
适于租赁的灵活型设计
Flexible design



办公/会议

Office / Meeting room module

独立办公室-员工

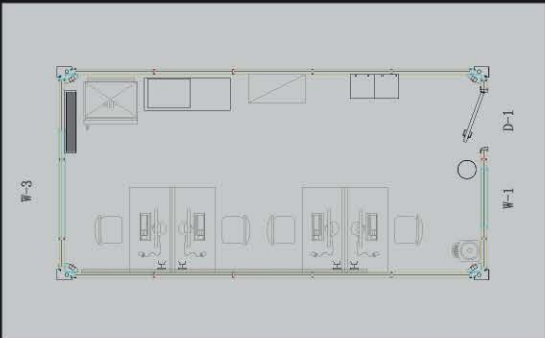

独立办公室-经理

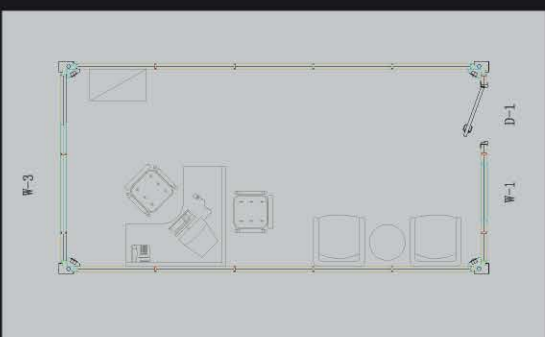

两连栋开放式办公区

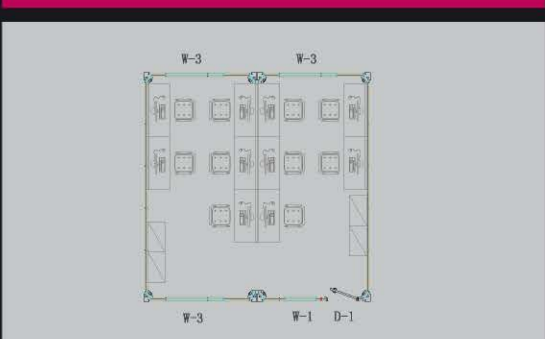

四连栋开放式办公区

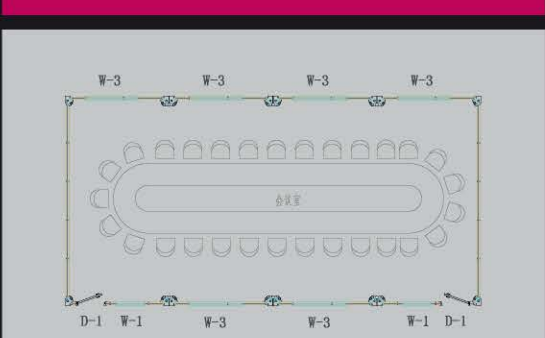



卫生间模块

Sanitary module

公共卫生间-男女

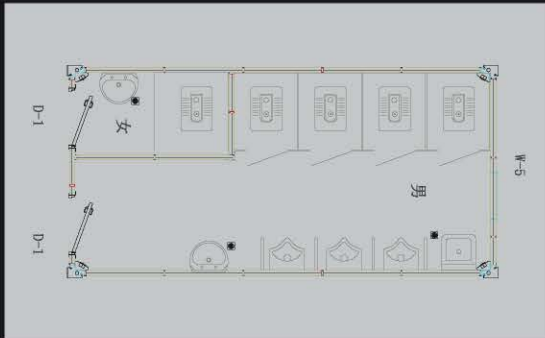

公共卫生间-马桶

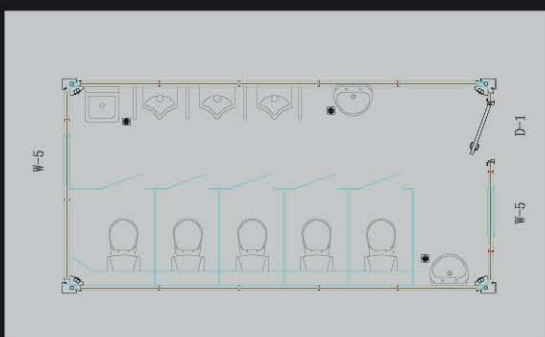

淋浴卫生间

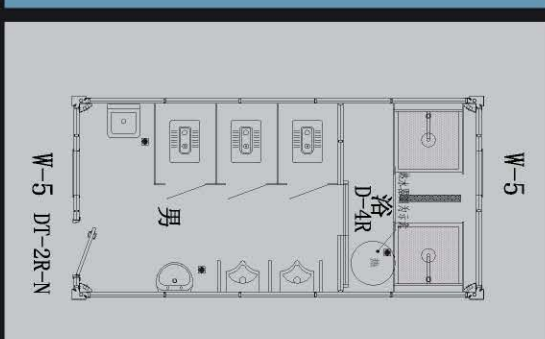

其他-定制卫生间

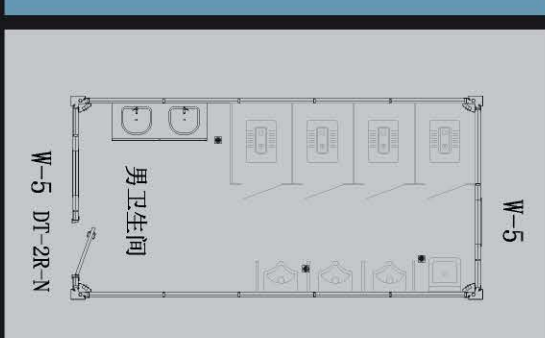





淋浴及盥洗模块 >  
Shower/Washing module

淋浴间



淋浴盥洗间



盥洗间



其他功能模块 >  
Other functional modules

厨房模块



餐厅模块



住宿模块



带独立卫浴模块





其他功能模块

>

Other functional modules

闸机模块

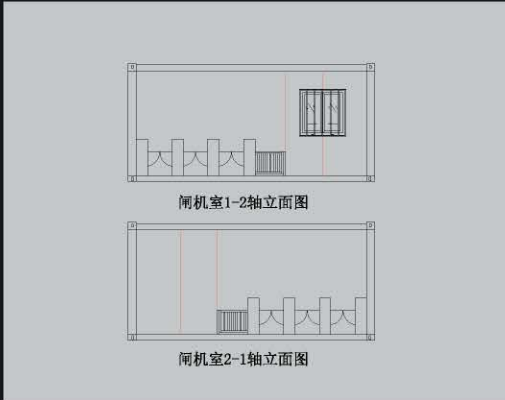

门厅模块

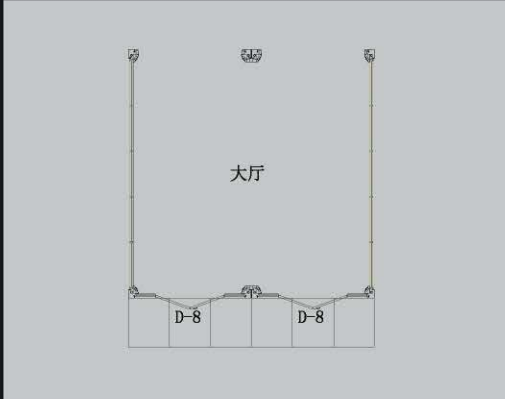

楼梯模块

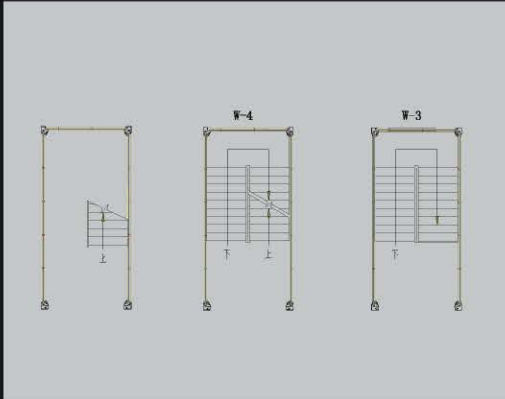

其他功能模块

>

Other functional modules

走廊箱模块

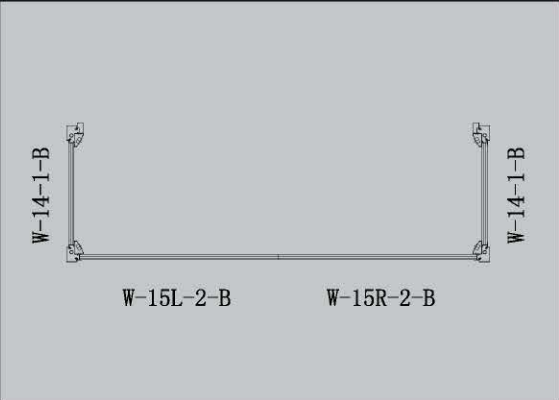

8米加高模块-接待室

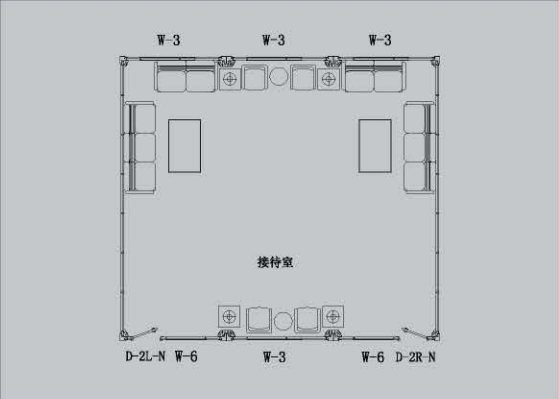

8米加高模块-会议室

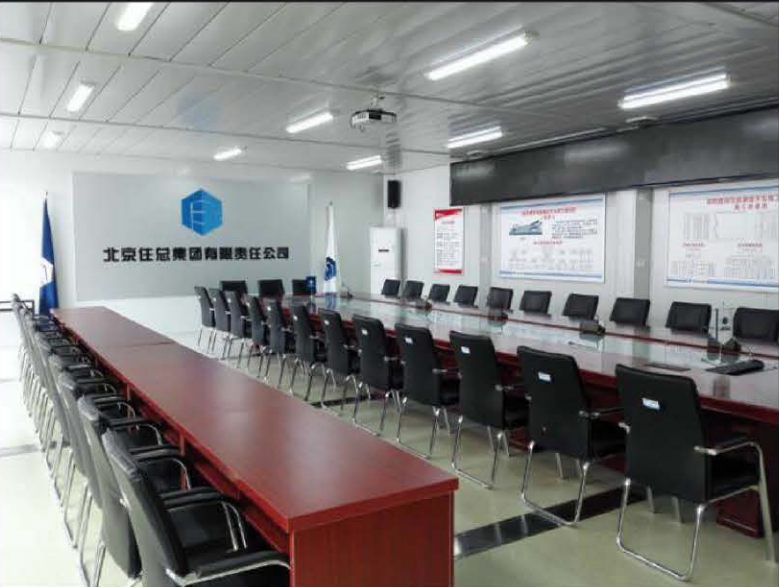
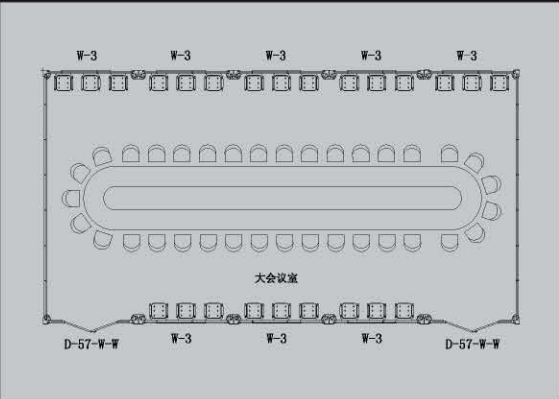



## L型设计布局图

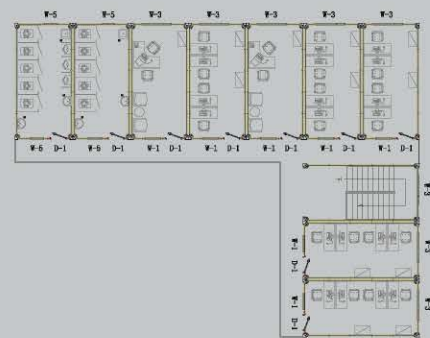

## 双排阳光板内走廊布局

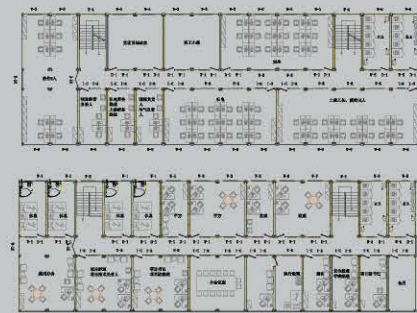

## U型设计布局图

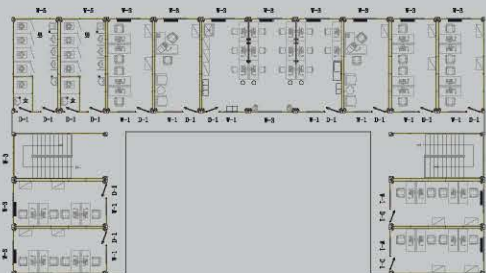

## 多排方案布局

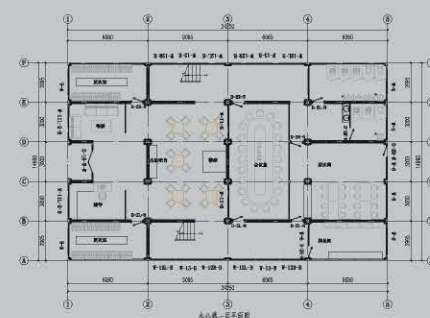



# 完备的解决方案

## Full Turkey Solutions

Follow Algeco 's modern concept of 360° services, Algeco Chengdong provide turnkey solutions for Chinese customers, it's not only about the product, but also technical solutions, such as network, safety, and security technologies. Even the services you're awareness, but important to the future operation, such as management of a modular building, maintenance, ect.



沿袭Algeco全球服务模式，安捷诚栋在中国继续推行360度服务，360服务包含的不仅是产品，更覆盖模块房相关的所有解决方案及服务，甚至是您还没有意识到的但却影响您后期使用的诸多服务，如装饰装修，维护保养，项目转移，运营管理等等。

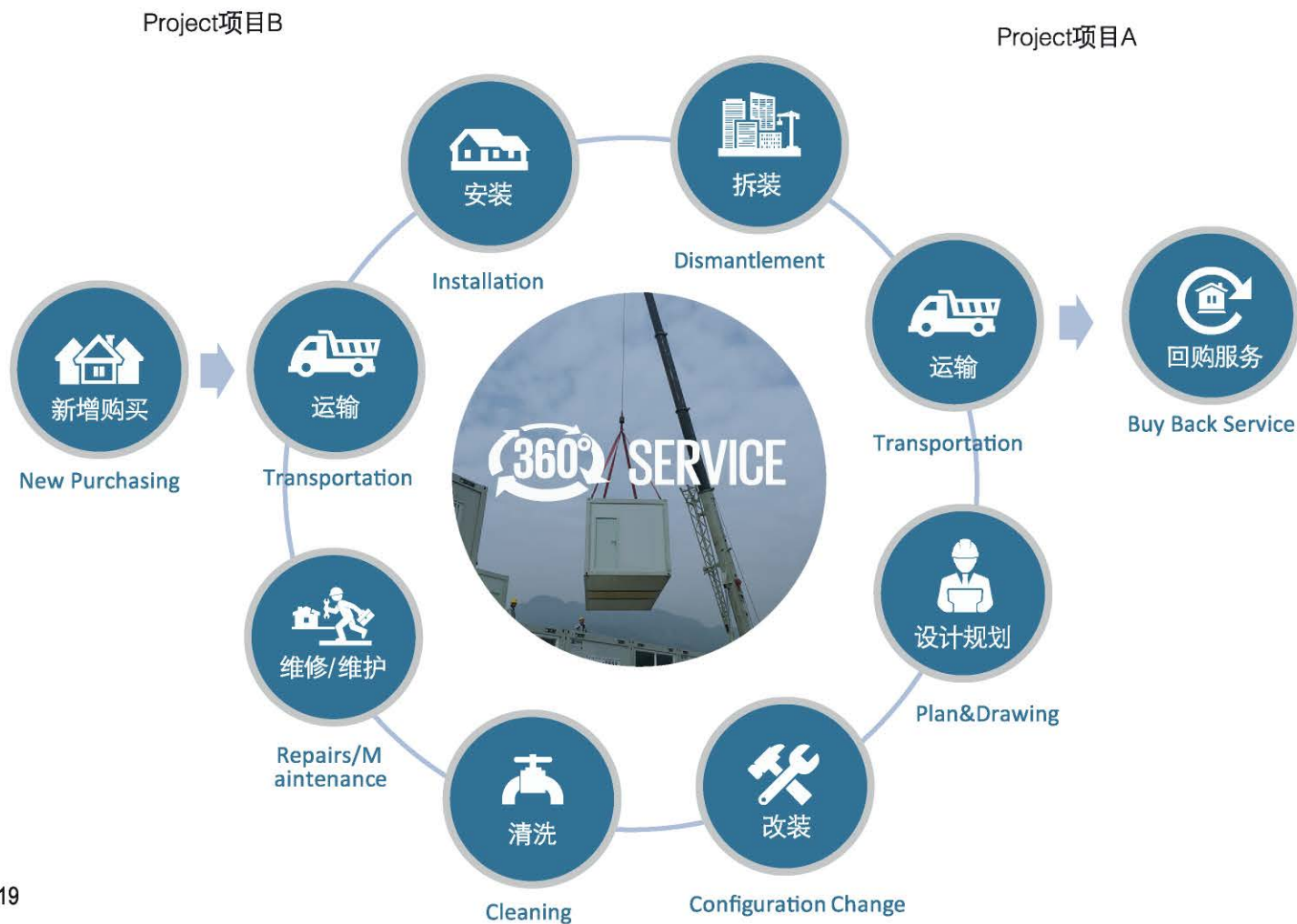

# 租赁的优势

## Leasing: A Modern Solution

### 1 优化投资

Optimised investment

- 分期付款，减少资金占用，专注投资核心业务
- 根据实际情况，可灵活的增加或减少用房数量，节省成本
- Payment by installment, reduce capital occupation, allocate your capital to your core business activity
- Flexibility to Increase or decrease your space according to situation, reduce your cost

### 2 降低成本

Cost reduction

- 租金抵费用，减少所得税缴纳税金；
- 在项目结束后，无需额外花钱搬运、存储和维护模块房以及清理现场
- Rent against charge, reduce income taxes
- No cost at the end of the project related to removal、storage、maintenance of the modules and site cleaning

### 3 规避风险

Risk control

- 有效避免政策变更及产品更新换代所带来的采购风险
- Effectively avoid purchasing risk related to regulation change and product update

### 4 租赁配套服务齐全

Full range of services

- 交钥匙工程，让您充分享受箱式房租赁为您带来的便利和轻松
- Turn-key program, make you enjoy the ease and benefits of modular space leasing

### 5 节能环保

Environment-friendly

- 重复利用 提高建筑使用效率 减少建筑垃圾
- Repeated use, increase service efficiency of buildings, reduce construction waste

### 6 交货期短

Short Leadtime

- 库存标准模块，可随时交货
- Stock available for standard modules



# 拆装移地服务

## Project Transfer & Relocation

### 专业服务，高灵活性产品，实现“无损化”拆装移地

项目A到B从来都不是简单转移。其中包括拆装、移地，更换布局设计、清洁、保养、修护、根据项目的实际要求提供最适合的解决方案。

高灵活性产品设计，轻松适应项目改变。同时，保证在反复拆装下损耗几乎为零，日常维护维修变得简便和轻松。它不仅满足客户多次和长期使用、增减方案，改变布局等不同的需求，更有力的帮助客户降低成本。

### Professional Service, High Flexible Product, Ensures “0 damages” for Relocation

Project Transfer is always not a simple transportation from A to B, but includes dismounting, relocation, change configuration, cleaning, preventive protection, maintenance... According to the specific demand, we'll provide the best and the most suitable solutions.

Modular standardization enables to, easily, adapt to any change of building configuration, with high level of flexibility and short lead-time. Routine maintenance is simple and easy during the very long life of the modules. Thus total cost is effectively reduced for customers, during the multi-usages, in multi-configurations of the module.

# 实际案例

## Case Study

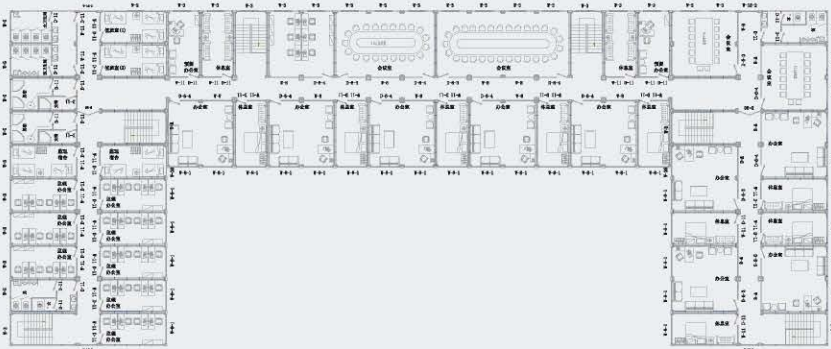

01

### 项目初始

Initial Solution

- 项目投入使用时间：2016年12月
- 方案：181个箱式房双排内走廊U型2层设计
- Completed time: Dec. 2016
- Total 181 modules
- U shape Design
- 2 storeys, with internal corridor



02

### 二次转移

After Transfer and Relocation

- 项目投入使用时间：2018年7月
- 方案：191个箱式房双排内走廊L型3层设计
- Completed time: July 2018
- Total 191 modules
- L shape Design
- 3 storeys, with internal corridor

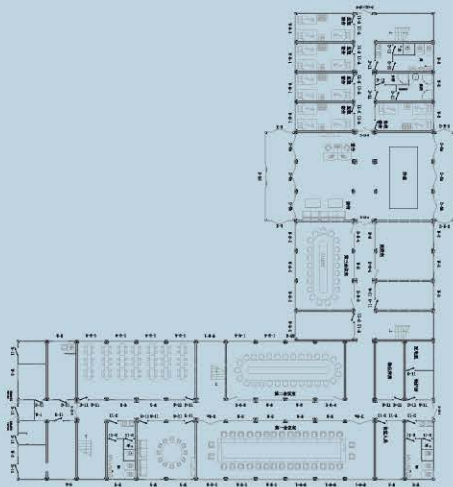

### 拆装及安装共计10天

Overall in 10 days!

- 由于功能调整，收回6个功能间，新增16个办公模块。
- 房体无破损，重复利用率100%
- 新增材料成本为0
- Return to stock : 6 modules
- New delivered: 16 modules (working space expanded)
- “0” damage, 100% reuse
- “0” maintenance cost





在安捷诚栋，您将享受一站式服务，  
得到您需要的任何解决方案>

At Algeco Chengdong, you get everything from one source



## 家具及电器配套

Furniture & Electrical Equipment

1 转椅 Swivel Chair

2 办公椅 Office Chair

3 文件柜 Filing Cabinet

4 更衣柜 Wardrobe

5 可移动小柜 Removable Cabinet

6 打印机小柜 Small Cabinet

7 办公桌 Table

8 空调 Air Conditioner

9 小冰箱 Mini-bar

10 电暖气 Heater

11 热水器 Solar Water Heater

12 高低床 Bunk Bed

13 冰箱 Refrigerator



办公椅 Office Chair



办公椅 Office Chair



办公椅 Office Chair



办公桌 Table



空调 Air Conditioner



文件柜 Filing Cabinet



文件柜 Filing Cabinet



更衣柜 Wardrobe



办公桌 Table



可移动小柜 Removable Cabinet



高低床 Bunk Bed



热水器 Solar Water Heater



冰箱 Refrigerator



小冰箱 Mini-bar



电暖气 Heater



打印机小柜 Small Cabinet





## 房体配套及方案 Ancillary products & Solutions

- 房体配套 Ancillary products  
搭配精选的配套产品，完善您的模块房方案，提升美观及实用性。
- 配套方案 Solutions  
细节决定品质，专业的解决方案，更便捷您的使用，延长您的模块房使用寿命。

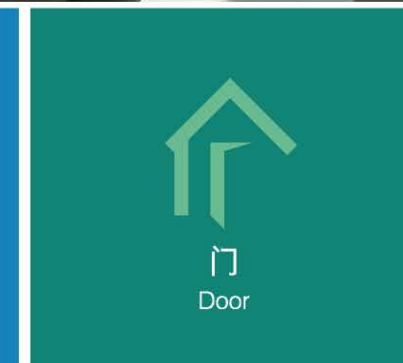
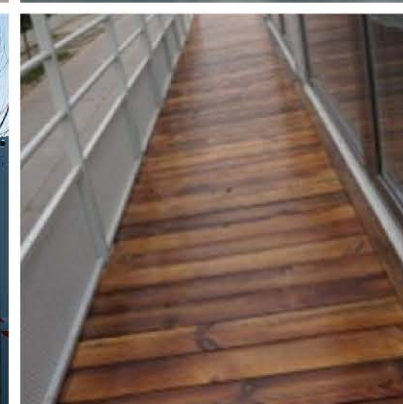
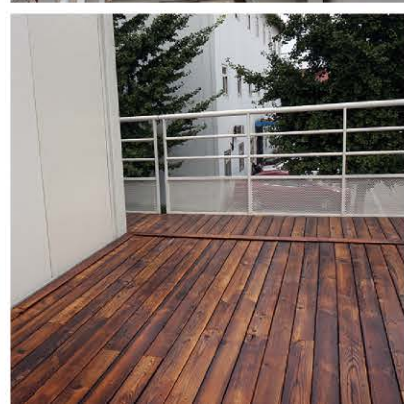



# PROJECT CASE

## 雄安群众 工作中心项目

从接到客户联系到安装交付，共“100小时”  
Completely done in “100” hours

- 箱体数量：93个
- 特殊房型：加长加高箱
- 项目地点：河北省雄安
- Project Quantity: 93 modules
- Special development: 8 meters module (longer and higher)
- Location: Xiong An, Hebei

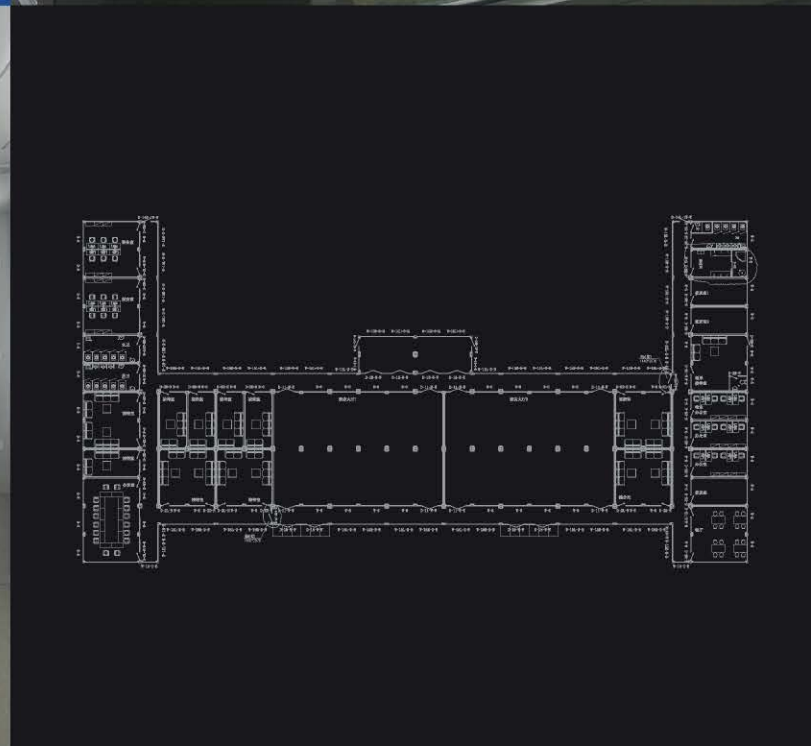
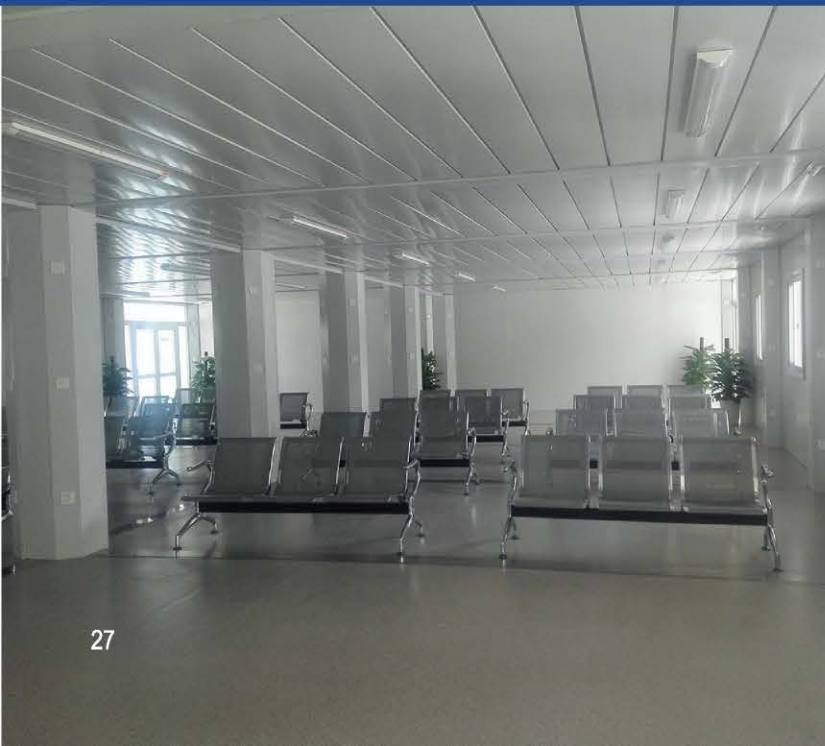



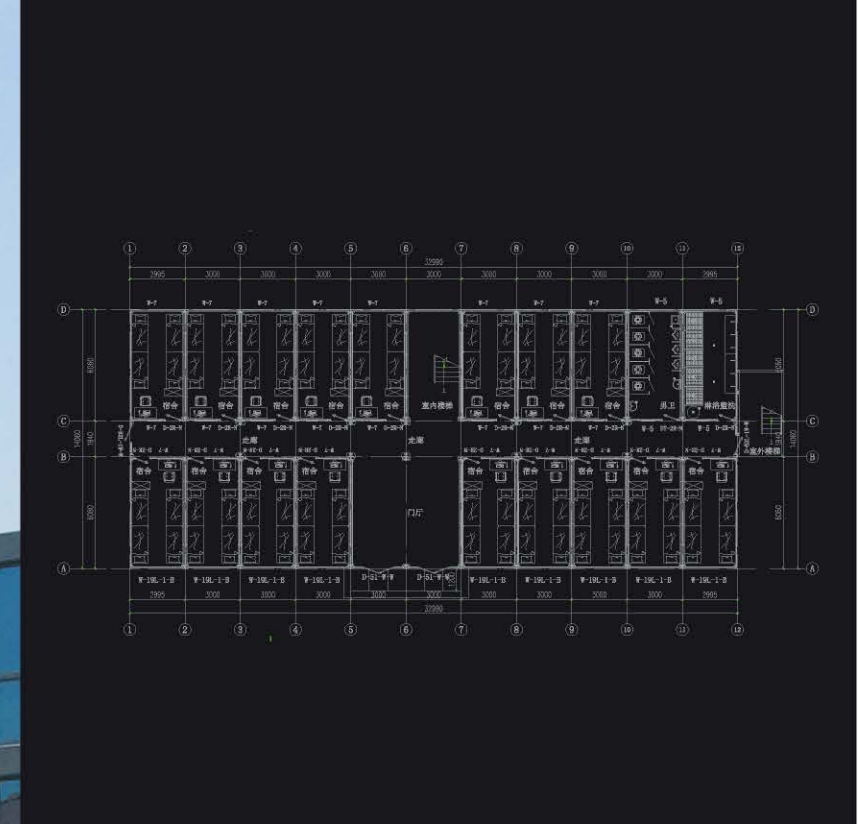

## 新奥集团副中心

- 箱体数量：1600个
- 方案：双排内走廊设计，香槟金镀膜大玻璃落地窗
- 完工时间：30天！
- 项目地点：北京市通州区
- Project Quantity: 1600 modules
- Special development: internal corridor layout; Glass wall design
- Whole project completed in 30 days!
- Location: Tongzhou, Beijing





# PROJECT CASE

## 大陆汽车项目

- 箱体数量：50个
  - 项目类型：租赁项目
  - 时长：18个月
  - 除房体外，我们提供了丰富配套产品：桌椅，空调，电暖器，窗帘等
  - 一层使用半年后，扩展为二层设计，新增箱体27个
  - 丰富的悬挂解决方案，使箱体不受破损
- Project Quantity: 50 modules
  - Leasing Project
  - Duration: 18 months
  - Full VAPS: Chair, Table, Air-conditioning, Heater, Curtain.....
  - Additional 27 modules added after using one and half a year.
  - Layout changed from one storey to 2 storeys.
  - Rich solutions provided for hanging (Wall poster, Heater, Curtain, Air-conditioning.....)

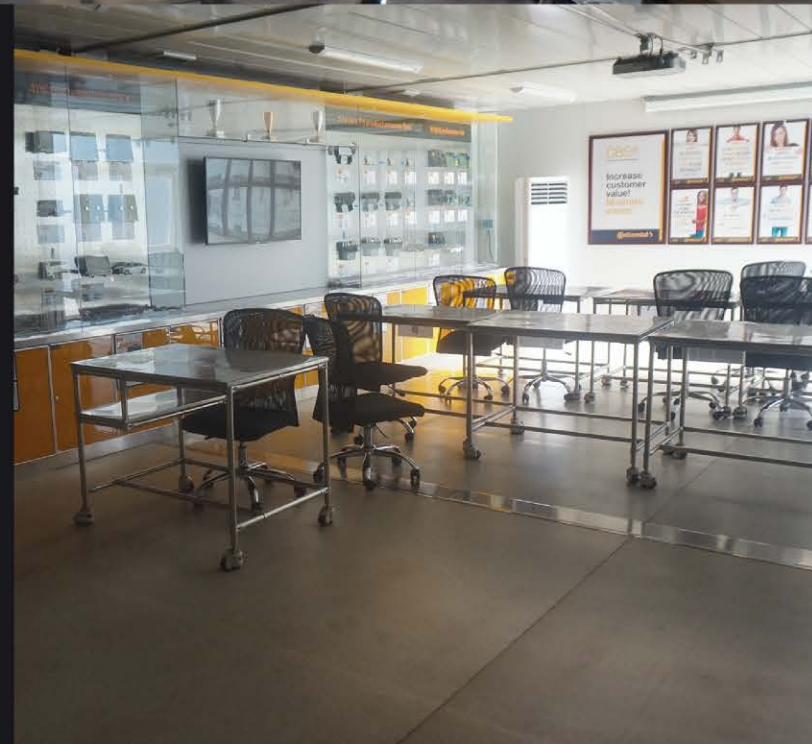
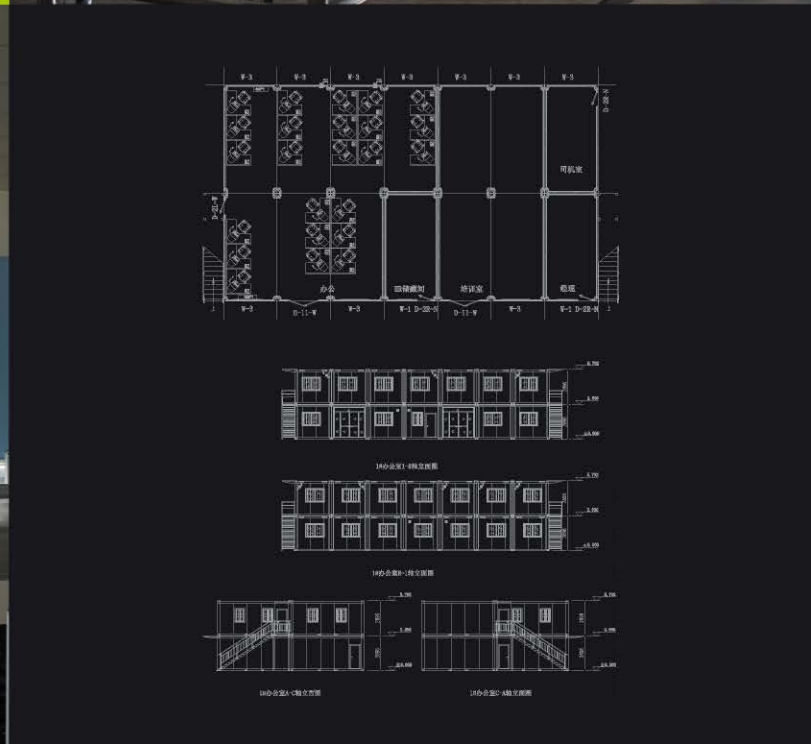



工程案例 >  
Project Cases

北京建工 城市副中心项目



北京建工地铁六号线



北京城建大兴机场项目



北京城建速滑馆项目



北京住总 通州副中心项目



北京住总北京项目



北京城建亚投行项目



中铁六局京张铁路



北京住总集团 副中心保障房



副中心市政府指挥部



中铁十二局京唐高铁



中铁二十一局地铁项目





工程案例 >  
Project Cases

中建八局延庆项目



中建二局项目



中铁十四局上庄项目

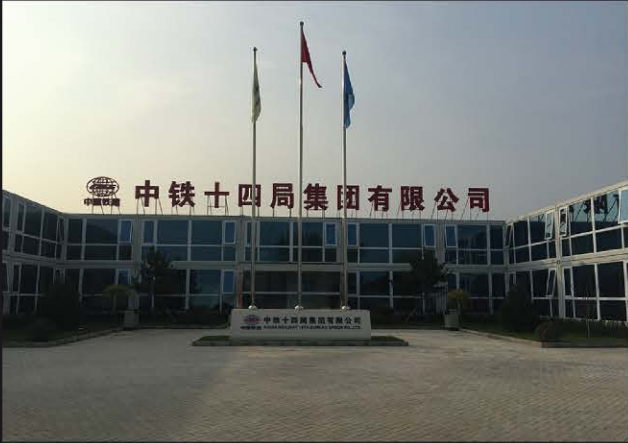

中铁十八局天津项目



中建六局天津地铁项目



北京市政路桥项目



中铁建工华北分公司北京项目



广东南沙项目



广西大藤峡项目



山西一建石景山项目



中信建设项目



鲁能地产项目





工程案例 >  
Project Cases

IKEA广州项目



DURR 北汽项目



世界田径锦标赛项目



翔翼飞鹰无人机项目



西门子奔驰项目



中汽工程徐水项目



浪琴马术大师赛项目



筑绿清源项目



南京旅游休闲项目



青海房车露营项目



北京观象台项目



无人便利店

